

AGILITY TRIAL PREMIUM LIST
NADAC Sanctioned
(North American Dog Agility Council, Inc.)



Hosted by

All Colorado Agility Team

Feb. 5, 6, and 7, 2010

Elbert, CO
Indoors on Dirt

Judge:

Susan Perry
Port Orchard, WA

Levels Offered:
Elite, Open, Novice

Categories Offered:
Skilled and Proficient

Classes Offered Friday:

Two Rounds of Weavers, One Round of Tunnelers

Classes Offered Saturday:

One Round of Tunnelers, One Round of Jumpers, One Round of Touch N Go,
One Round of Chances, Two Rounds of Regular Agility

Classes Offered on Sunday:

Two Rounds of Regular Agility, One Round of Chances,
One Round of Touch N Go, One Round of Jumpers

Divisions Offered:

Standard in all Classes

Veterans and Junior Handler in Chances, Regular Agility, and Jumpers
Veteran Handlers in Touch N Go, Tunnelers, and Weavers

No Entries Will Be Accepted With A POSTMARK DATE Before: Dec. 29, 2009

Closing Date: 6:00 PM Jan. 22, 2010 or 500 runs a day (350 jumping runs) whichever occurs first

Trial Secretary – Liz Williams –ACAT Trial

30080 David Rd
Pueblo, CO 81006

Website: <http://www.WAppraisal.com/Agility/acat.html>

Please read the entire premium. We have made changes to our premium.

ENTRY INFORMATION: PLEASE READ YOUR CONFIRMATIONS OVER CAREFULLY. NO CHANGES WILL BE MADE AT THE TRIAL.

Our Microsoft Word entry form allows you to type in your information. Please use this option as it makes it so much easier to read entry information. Please make sure your e-mail address is legible as we send out confirmations, show instructions, and results via e-mail. If you have changed your e-mail, mailing address, phone number, or any other information, please highlight this information for us when you submit your entry.

We utilize the Agility Unscrambled program which allows e-mail confirmations and results dissemination. We will send out electronic confirmations and electronic results after the trial. Please make sure your e-mail address on your entry form is legible.

DAILY FEES AND PACKAGE RATES:

- Each individual run: \$9
- Full weekend package (all 14 runs): First Dog: \$110, Additional Dogs: \$105 each
- Saturday & Sunday Runs (all 11 runs): First Dog: \$90, Additional Dogs: \$85 each
- Eight runs for the weekend: \$70
- Junior Handlers: \$5 a run for all classes
- Day of Show Entry for Friday: \$10.00 Per Class
- Day of Show Entry for Saturday and/or Sunday: \$10.00 Per Class

Please note – there are no Package's available for Day of Show Entries

DAY OF SHOW ENTRIES:

Friday Classes: Day of show entries will be accepted until 2:45 PM with a cost of \$10 a run. Please note; if you arrive at 2:45 PM there will be a good possibility that one of the classes may already be completed.

Saturday & Sunday: We will accept day of show entries for Saturday and/or Sunday provided the trial has not filled. The day of show entry fee is \$10 a run with no package deals. Day of show entries will only be accepted during check-in and must be completed before the morning General Briefing. It is recommended that you e-mail izziew@wappraisal.com the week before the trial to see if we have room for Day of Show Entries.

REMEMBER: Any printed running order is always very tentative. We will do our best to separate dogs run by the same handler in the same class.

ENTRY DATA: Entries with postmarks BEFORE Dec. 29, 2009 will not be accepted. The entry postmark date will be the determining factor for entry acceptance order. There is no need to overnight entries. The trial closing date is Jan. 22, 2010 at 6:00 p.m. **We reserve the right to refuse any entry. Anyone who is not currently in good standing with NADAC will not be allowed entry into the trial.**

There shall be no refunds for entries withdrawn in the event a dog and/or handler is dismissed from competition, regardless of the reason for such dismissal. Refunds are allowed if requested before the closing date. Refunds after the closing date will be honored only for bitches in season. A \$10.00 processing fee per dog will be assessed for ANY refund. No entry fee will be refunded if the trial cannot open or be completed by reasons of riots, civil disturbances, fire, weather, acts of God, public emergency, an act of a public enemy, or any other cause beyond our control.

Accepted entries may be changed prior to Jan. 22, 2010 at 9:00 p.m. E-mail change requests to izziew@wappraisal.com or by calling 719-252-1009 (NOTE: e-mail is highly preferred). No changes will be made at the trial, so please read your confirmations carefully. If you have questions, e-mail.

E-mail confirmations will be sent; Please read over your confirmations carefully. We all make errors and we will certainly make corrections as long as we are notified prior to the closing date as that is when scribe sheets and running orders are printed. If by chance you entered and did not get an e-mail, please e-mail me to check.

Exhibitors, through submission of entry, acknowledge that they are knowledgeable of NADAC rules and regulations, and agree to abide by all rules in effect at the time of this trial. A copy of the current Exhibitors Handbook may be downloaded free from the NADAC web site: www.nadac.com

Any person who writes a check for “insufficient funds” and/or otherwise a “bad check” will not be allowed to participate in this event until a money order or cashier’s check for the amount of the original check; plus \$40.00 returned check fee is received.

VETERAN HANDLER: Handlers aged 60 years or older or disabled handlers may opt to enter Touch N Go, Tunnelers, and/or Weavers as a Veteran Handler which allows you to receive 10% more standard course time. This division is for Veteran Handlers only. If entered as a VH all classes are veterans for all dogs entered by that handler.

SITE INFORMATION:

The Trial will be indoors on dirt. Parking is fairly close to the ring. **This facility’s crating space will be at a premium. Please be considerate and efficient with your setup (stacked crates, X Pens with multiple dogs only, etc.) The show committee reserves the right to limit crating space as needed.**

COMMUNICATING WITH TRIAL SECRETARY:

E-mails sent to izziew@wappraisal.com regarding trial 'stuff' will be responded to within 4 days (usually within one day on weekdays). Funny things happen in cyberspace; e-mails get lost, e-mail addresses cannot be read, spam filters, etc., so if you send an e-mail and do not get a response within 4 days, please e-mail again. If you entered the trial but did not get a confirmation, please e-mail. Don't worry about 'bugging' the Trial Secretary. Please read over your confirmations carefully. We all make errors and we will certainly make corrections as long as we are notified prior to the closing date as that is when the catalog and running orders are printed.

TRIAL RUNNING ORDER INFORMATION:

Friday: Check in at 2:15 pm and walk through at 2:45 pm. Runs beginning no earlier than 3:00 PM.

Saturday & Sunday: 7:30 am Check-in and 7:45am Walk Through times, First dog on line at 8:00am

Please do not arrive at the trial site before 6:30 AM

Day of Show entries will be taken during check-in.

NADAC INFORMATION: For detailed information about NADAC rules and classes go to www.nadac.com

SKILLED CLASS: As of Jan. 1, 2009 all dogs entered in skilled must take a 4” jump height reduction

ORGANIZING COMMITTEE

Trial Chair:	Pam Smith, pamsmith@zianet.com 575-525-1530
Trial Secretary:	Liz Williams, izziew@wappraisal.com 719-252-1009 30080 David Rd., Pueblo, CO 81006
Web site is:	http://www.WAppraisal.com/Agility/ACAT.html
Chief Score Keeper:	Dee Falk
Chief Ring Steward:	Lorrie Reynolds
Equipment Manager:	Jackie Schiferel
Show Hospitality:	Liz Williams
Chief Course Builder:	Linsey Cooper & Dawn Griebelbauer

AWARDS: First through fourth place ribbons will be awarded for each jump height in all categories, levels, and classes (except Chances which has no placements). Qualifying ribbons will be awarded for any qualifying score.

IMPORTANT! Please check your dog's NADAC registration number on your trial confirmation as soon as you receive it; also, please check the copy of the results posted at the trial. You should report any errors to the Trial Secretary immediately. NADAC records trial results as they are submitted by the host clubs/groups. The individual trial results submitted by the club are uploaded to the files section of the NADACagility@yahoo.com list within two weeks after the NADAC office receives them from the club. The trial results will remain on the list for at least thirty (30) days. Please accept the responsibility to review those results, and check that your registration number and qualifying points, as reported by the club, are correct. You can join the www.NADACagility@yahoo.com list and set your settings to "no mail". You will be able to view trial results and check for any possible discrepancies, without receiving list mail. If you find an error in the reporting of your dog's qualifying points or registration number, please contact the host club. The host club is responsible for correcting any errors and informing NADAC.

Levels. Points earned at a higher level of a class, prior to the completion of the lower level title, will not be banked by NADAC for future use. If a dog earns points in a level of a class that they are not eligible to title in, those points will not be added to the dog's records.

DIRECTIONS:

From Colo. Springs: Take Hwy 83 North to Hodgen Rd. Go east to Meridian Rd. Then south on Meridian to Latigo, take Latigo east to the 2nd Halleluaiah Trail entrance, turn left, the Equestrian Center will be on the right.

Or, take Woodmen east to Meridian. Go north on Meridian approx. 5 miles to Latigo Blvd. Go east on Latigo to 2nd Halleluaiah Trail entrance, turn left, the Equestrian Center will be on the right.

From I-25, North(Denver): Get off at Monument Exit and head east on CR105 to SR83, go right and go south 2.7 mi to Hodgen Rd. Turn left on Hodgen and go east 8.6 mi to Meridian, Turn right on Meridian and go south 4.9 mi to Latigo Blvd. Left on Latigo and go east 1.4 mi to the 2nd Halleluaiah Trail entrance, turn left, the Equestrian Center will be on the right.

MAP

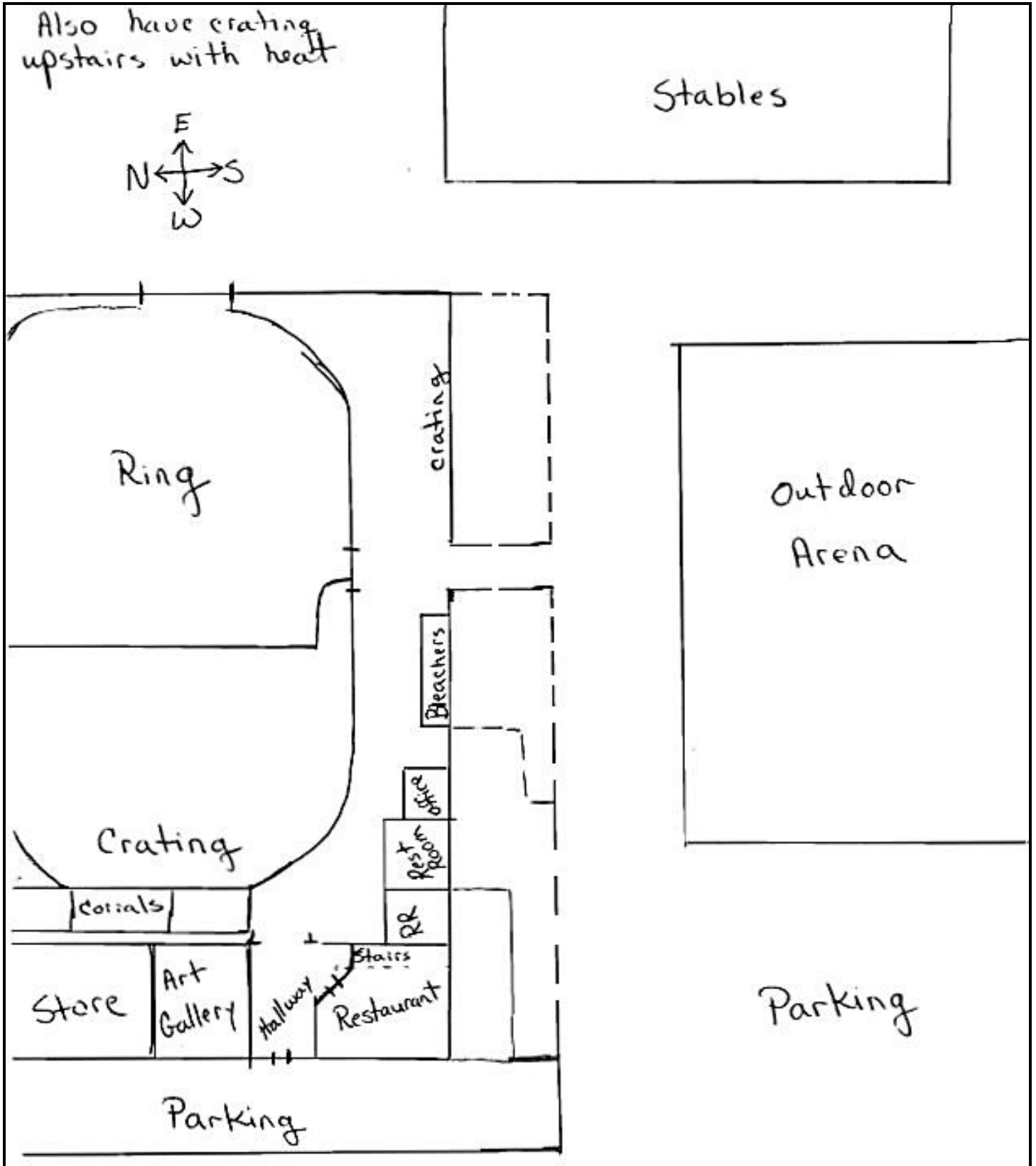

OBSTACLES: The following obstacles are available for use at this trial:

Dog Walk (Rubber Surface)
Non-Wing Jumps

A Frame (Rubber Surface)
Open Tunnels

Weave Poles

FACILITY ADDRESS:

Latigo Trails Equestrian Center; 13110 Halleluia Trail; Elbert, CO **NO dogs will be allowed in the restrooms.**

HOTELS/MOTELS Please double check to see if hotels accept dogs.

REMEMBER to pick up after your dogs.

Microtel Inn & Suites, 7265 Commerce Center Dr. 719-598-7500. Continental Breakfast 6:30-9:30 AM

Will waive \$20 pet fee if you identify yourself as attending ACAT Agility Trial.

Drury Inn, 8155 N. Academy 719-598-2500. Buffet Breakfast 7-9 AM

No additional charge for dogs.

Super 8, 8135 N. Academy, Exit 150 719-528-7100.

\$10 per day per dog additional charge.

There is RV Parking and tent camping allowed on site. No hookups or showers are available. Please email Liz at izziew@wappraisal.com if you are interested in camping on site.

WORKERS: Please fill out the enclosed worker form. We truly appreciate all the help we get at trials as we could not put on trials without the help of volunteers. If you have questions regarding 'Trial Jobs' a detailed description of each job is located at the following web site: <http://www.wappraisal.com/agility/acat.html>

NOTE: The volunteer form and the entry form are both a Microsoft Word Form – If you have Microsoft Word, you can type your name in the appropriate area and click on the boxes of your choice then print and send!

WORKERS: Please Help With Our Trial!

If everyone pitches in, the trial will go more quickly and smoothly. We greatly appreciate your help. We have worker coupons for those who help which are good for any future ACAT show. **Please fill out this form completely. The volunteer coordinator does not see your entry form!!!**

Name: _____

I can work the following days:

- Friday, Feb. 5, 2010
- Saturday, Feb. 6, 2010
- Sunday, Feb. 7, 2010

Please check the classes you are entered in or **cannot** work with an x:

Friday:

- Weavers Rnd 1 (Elite, (Open, (Nov)
- Weavers Rnd 2 (Elite, (Open, (Nov)
- Tunnelers Rnd 1 (Elite, (Open, (Nov)

Saturday:

- Tunnelers Rnd 2 (Elite, (Open, (Nov)
- Jumpers Rnd 1 (Elite, (Open, (Nov)
- Touch n Go Rnd 1 (Elite, (Open, (Nov)
- Chances Rnd 1 (Elite, (Open, (Nov)
- Regular Rnd 1 (Elite, (Open, (Nov)
- Regular Rnd 2 (Elite, (Open, (Nov)

Sunday:

- Regular Rnd 3 Elite, (Open, (Nov)
- Regular Rnd 4 (Elite, (Open, (Nov)
- Chances Rnd 2 (Elite, (Open, (Nov)
- Touch n Go Rnd 2 (Elite, (Open, (Nov)
- Jumpers Rnd 2 (Elite, (Open, (Nov)

Note: We will sign you up to work only two classes each day unless you indicate otherwise.

Check here _____ if you will work more than two classes each day.

I am willing to work in the following capacities:

- Anything Gate Steward Jump Setter
- Leash Runner Scribe Scribe Assistant
- Scribe Runner Timer Course Builder
- Load Truck, Tear Down, Clean Up Sunday Afternoon

Cheerful and thorough training is available for ANY job!

Please send this in to volunteer!!

You get a coupon for \$1.50 for each class worked. It is good towards any future ACAT/SCAT trial.

Thank you!

Remember, send in a copy of your permanent height card and you don't have to check in.